



# 2807 W Kingshighway Paragould, AR

**Jason Gazaway**  
Gazaway Realty, Inc.  
2210 W Kingshighway  
Suite 9  
Paragould, AR 72450  
[jgazaway@gazawayrealty.com](mailto:jgazaway@gazawayrealty.com)  
(870) 236-1115 Office  
(870) 236-1114 Fax  
(870) 215-1300 Cell

**Ryan George**  
Coldwell Banker Commercial  
Village Communities  
2704 S Culberhouse  
Jonesboro, AR 72401  
[ryangeorge72471@gmail.com](mailto:ryangeorge72471@gmail.com)  
(870) 935-7800 Office  
(870) 935-4581 Fax  
(870) 974-1249 Cell

2807 W Kingshighway, Paragould, AR

## For Sale or Lease



### Location:

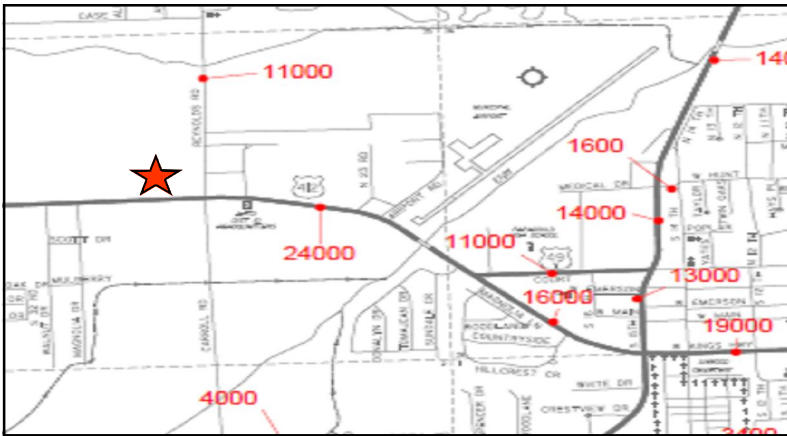

### Features and Amenities:

- \$517,000.00 or \$3,500.00 per month
- .92 Acres
- Prime Retail Site
- 1400 SF Building
- Zoned C-3
- Reception area (2)
- 3 Private Offices
- 2 Bathrooms
- High Traffic Count



Jason Gazaway  
2210 W. Kingshighway Ste 9  
Paragould, AR 72450  
(870) 236-1115 Office  
(870) 215-1300 Cell  
jgazaway@gazawayrealty.com



Ryan George  
2704 S Culberhouse  
Jonesboro, AR 72401  
(870) 935-7800 Office  
(870) 974-1249 Cell  
ryangeorge72471@gmail.com

For more information on this property and all of our available properties, go to  
[www.gazawayrealty.com](http://www.gazawayrealty.com) or  
[www.coldwellbankerjonesboro.com](http://www.coldwellbankerjonesboro.com)

**Disclaimer:** The information presented herein, while not guaranteed, was obtained from sources we believe to be reliable.



**CINEMA 8**  
Paragould

**COUNTRY MART**

**LIBERTY BANK**  
OF ARKANSAS

**SUBWAY**

**1ST** First National Bank

412

W Kings Hwy

The  
**Dixie**  
Cafe

**ACE**  
Hardware

**WAL\*MART**

Google

Image State of Arkansas  
Data SIO, NOAA, U.S. Navy, NGA, GEBCO

© 2010 Google

# 2807 W Kingshighway





2807 W Kingshighway, Paragould, AR  
72450-2605

Site Type: Ring

Radius: 1 Miles

Radius: 3 Miles

Radius: 5 Miles

## 2009 Population

	Radius: 1 Miles	Radius: 3 Miles	Radius: 5 Miles
Total Population	2,857	21,286	27,465
Male Population	48.7%	48.1%	48.5%
Female Population	51.3%	51.9%	51.5%
Median Age	39.2	38.8	38.2

## 2009 Income

	Radius: 1 Miles	Radius: 3 Miles	Radius: 5 Miles
Median HH Income	\$48,398	\$40,177	\$39,942
Per Capita Income	\$23,752	\$22,173	\$21,176
Average HH Income	\$59,655	\$52,855	\$51,437

## 2009 Households

	Radius: 1 Miles	Radius: 3 Miles	Radius: 5 Miles
Total Households	1,197	8,853	11,179
Average Household Size	2.28	2.35	2.41

## 2009 Housing

	Radius: 1 Miles	Radius: 3 Miles	Radius: 5 Miles
Owner Occupied Housing Units	66.4%	57.8%	59.7%
Renter Occupied Housing Units	22.5%	31.5%	30.1%
Vacant Housing Units	11.1%	10.7%	10.3%

## Population

	Radius: 1 Miles	Radius: 3 Miles	Radius: 5 Miles
1990 Population	1,840	17,024	21,447
2000 Population	2,438	19,758	25,101
2009 Population	2,857	21,286	27,465
2014 Population	3,044	22,202	28,821
1990-2000 Annual Rate	2.85%	1.5%	1.59%
2000-2009 Annual Rate	1.73%	0.81%	0.98%
2009-2014 Annual Rate	1.28%	0.85%	0.97%

In the identified market area, the current year population is 27,465. In 2000, the Census count in the market area was 25,101. The rate of change since 2000 was 0.98 percent annually. The five-year projection for the population in the market area is 28,821, representing a change of 0.97 percent annually from 2009 to 2014. Currently, the population is 48.5 percent male and 51.5 percent female.

## Households

	Radius: 1 Miles	Radius: 3 Miles	Radius: 5 Miles
1990 Households	717	6,879	8,466
2000 Households	999	8,104	10,068
2009 Households	1,197	8,853	11,179
2014 Households	1,284	9,275	11,784
1990-2000 Annual Rate	3.37%	1.65%	1.75%
2000-2009 Annual Rate	1.97%	0.96%	1.14%
2009-2014 Annual Rate	1.41%	0.94%	1.06%

The household count in this market area has changed from 10,068 in 2000 to 11,179 in the current year, a change of 1.14 percent annually. The five-year projection of households is 11,784, a change of 1.06 percent annually from the current year total. Average household size is currently 2.41, compared to 2.44 in the year 2000. The number of families in the current year is 7,490 in the market area.

## Housing

Currently, 59.7 percent of the 12,456 housing units in the market area are owner occupied; 30.1 percent, renter occupied; and 10.3 percent are vacant. In 2000, there were 11,020 housing units—60.4 percent owner occupied, 31.0 percent renter occupied and 8.6 percent vacant. The rate of change in housing units since 2000 is 1.33 percent. Median home value in the market area is \$104,520, compared to a median home value of \$162,279 for the U.S. In five years, median home value is projected to change by 2.74 percent annually to \$119,617. From 2000 to the current year, median home value changed by 4.91 percent annually.

Source: U.S. Bureau of the Census, 2000 Census of Population and Housing. ESRI forecasts for 2009 and 2014. ESRI converted 1990 Census data into 2000 geography.



2807 W Kingshighway, Paragould, AR  
72450-2605

Site Type: Ring	Radius: 1 Miles	Radius: 3 Miles	Radius: 5 Miles
<b>Median Household Income</b>			
1990 Median HH Income	\$24,978	\$20,363	\$20,213
2000 Median HH Income	\$38,120	\$30,995	\$30,924
2009 Median HH Income	\$48,398	\$40,177	\$39,942
2014 Median HH Income	\$48,899	\$42,713	\$42,476
1990-2000 Annual Rate	4.32%	4.29%	4.34%
2000-2009 Annual Rate	2.61%	2.84%	2.81%
2009-2014 Annual Rate	0.21%	1.23%	1.24%
<b>Per Capita Income</b>			
1990 Per Capita Income	\$11,173	\$10,721	\$10,211
2000 Per Capita Income	\$20,053	\$18,610	\$17,650
2009 Per Capita Income	\$23,752	\$22,173	\$21,176
2014 Per Capita Income	\$24,702	\$23,044	\$21,915
1990-2000 Annual Rate	6.02%	5.67%	5.63%
2000-2009 Annual Rate	1.85%	1.91%	1.99%
2009-2014 Annual Rate	0.79%	0.77%	0.69%
<b>Average Household Income</b>			
1990 Average Household Income	\$30,873	\$26,076	\$25,373
2000 Average Household Income	\$50,736	\$45,429	\$43,790
2009 Average HH Income	\$59,655	\$52,855	\$51,437
2014 Average HH Income	\$61,295	\$54,652	\$52,995
1990-2000 Annual Rate	5.09%	5.71%	5.61%
2000-2009 Annual Rate	1.77%	1.65%	1.76%
2009-2014 Annual Rate	0.54%	0.67%	0.6%

### Households by Income

Current median household income is \$39,942 in the market area, compared to \$54,719 for all U.S. households. Median household income is projected to be \$42,476 in five years. In 2000, median household income was \$30,924, compared to \$20,213 in 1990.

Current average household income is \$51,437 in this market area, compared to \$71,437 for all U.S. households. Average household income is projected to be \$52,995 in five years. In 2000, average household income was \$43,790, compared to \$25,373 in 1990.

Current per capita income is \$21,176 in the market area, compared to the U.S. per capita income of \$27,277. The per capita income is projected to be \$21,915 in five years. In 2000, the per capita income was \$17,650, compared to \$10,211 in 1990.

### Population by Employment

Total Businesses	181	940	1,136
Total Employees	2,104	12,683	16,113

Currently, 85.4 percent of the civilian labor force in the identified market area is employed and 14.6 percent are unemployed. In comparison, 89.4 percent of the U.S. civilian labor force is employed, and 10.6 percent are unemployed. In five years the rate of employment in the market area will be 89.6 percent of the civilian labor force, and unemployment will be 10.4 percent. The percentage of the U.S. civilian labor force that will be employed in five years is 92.9 percent, and 7.1 percent will be unemployed. In 2000, 62.7 percent of the population aged 16 years or older in the market area participated in the labor force, and 0.1 percent were in the Armed Forces.

In the current year, the occupational distribution of the employed population is:

- 51.4 percent in white collar jobs (compared to 61.5 percent of U.S. employment)
- 14.6 percent in service jobs (compared to 17.1 percent of U.S. employment)
- 34.1 percent in blue collar jobs (compared to 21.4 percent of U.S. employment)

In 2000, 83.1 percent of the market area population drove alone to work, and 1.9 percent worked at home. The average travel time to work in 2000 was 17.3 minutes in the market area, compared to the U.S. average of 25.5 minutes.

### Population by Education

In 2009, the educational attainment of the population aged 25 years or older in the market area was distributed as follows:

- 22.4 percent had not earned a high school diploma (16.2 percent in the U.S.)
- 40.5 percent were high school graduates only (29.8 percent in the U.S.)
- 3.7 percent had completed an Associate degree (7.2 percent in the U.S.)
- 9.8 percent had a Bachelor's degree (17.0 percent in the U.S.)
- 4.5 percent had earned a Master's/Professional/Doctorate Degree (9.8 percent in the U.S.)



# Executive Summary

Prepared By STDBonline

Source: U.S. Bureau of the Census, 2000 Census of Population and Housing. ESRI forecasts for 2009 and 2014. ESRI converted 1990 Census data into 2000 geography. Business data provided by InfoUSA, Omaha NE Copyright 2009, all rights reserved.